

**LOCATION DETAILS**

Location details of Mouza-Mahesh, J.L. No.-15 under Police Station Serampore, Ward No. 16, within the limits of Serampore Municipality, District Hooghly, Pin Code- 712201, West Bengal, With Project Name **Solaris City Serampore Phase 1B** with clear demarcation of land dedicated for the project along with its boundaries including the latitude and longitude of the project.

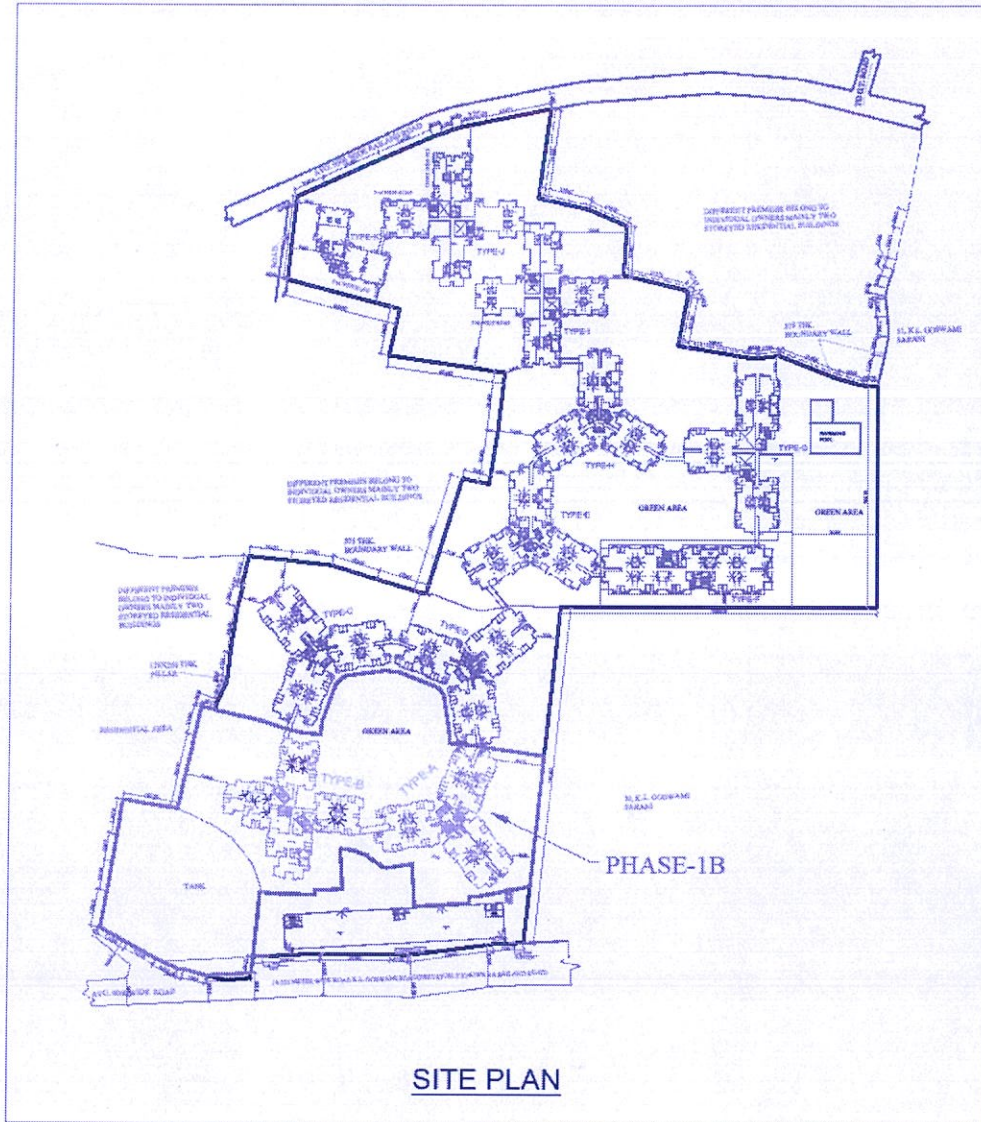

**The latitude and longitude of the center of the project:**

LATITUDE	LONGITUDE
22°44'20.45"N	88° 20'42.61"E

Place: Kolkata

Date: 07.07.2023

Page 1 of 1

Yours Faithfully

EDEN REALTY VENTURES PVT. LTD.

Eden Realty Ventures Pvt. Ltd. | Metropolitan Building Director  
7 J L Nehru Road | Kolkata 700 013 | India

+91 33 66264100 | info@ervpl.com | edenrealtygroup.com

CIN: U170101WR2003PTC095829